

THIS PHOTO: Light, bright, and full of angular character, this bath easily serves two guest suites with its dual vanities and welcoming vibe. **OPPOSITE:** Natural light spills off the room's polished marble surfaces.





NEW ANGLE

Unique details bring
architectural interest to this
lake-house guest bath.

writer CHRIS HAYHURST *photographer* WERNER STRAUBE *field editor* HEIDI PEARSON

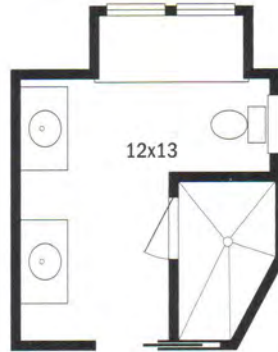

It's good to be different. That sentiment drove the design of this bath,

a character-filled space tucked just so beneath the Tudor-style angular rooflines of a Minnesota lake house. "It was about personality," says interior designer Willis Watts, recalling the approach he took on the project. "It was, 'What can we do here to make it different from the other bathrooms in the house?'"

The room serves two second-floor guest suites, and right from the start Watts and architectural designer Jeff Murphy decided the space should have two separate vanities so visitors could get ready simultaneously. They nixed the tub—with a lake outside, would guests ever take a bath?—and focused on the shower. The space is cheerful and cool, with natural light and neutral tones in the white cabinets, off-white walls, gray-and-white tiles, and Calacatta Gold marble countertops. Lines are simple and functional, modern yet elegant—just dressy enough to make guests feel pampered. "We wanted it to feel lively and spacious, with lots of interesting, unique details," Murphy says.

Those details include a double-arched recess with a built-in marble shelf above the toilet. Next to it, a hardworking window niche that's dressed with a slab of marble provides display space, shelf space, and a sunny spot to sit after showering. The shower itself traces the contours of the home's rooflines, so one wall climbs up at an angle. "It makes it feel cozy in there," Murphy says. "But it's still very light, and you have all the space you need."

Across from the shower, the vanities bring panache with their marble tops, vintage mirrors, tubular sconces, and nickel faucets. The vanities are meant to be "simple, not overly busy," with hints of the traditional together with the contemporary, Murphy says. "We wanted it to be a bit unexpected."

The unexpected, of course, is what gives this room its one-of-a-kind appeal. The way Watts sees it, he and Murphy could have been flustered when they began designing this bath—after all, their clients had high expectations and little maneuvering room in which to meet them. "But instead, the potential complications became opportunities to create interest," Watts says. **KBI**

RESOURCES BEGIN ON PAGE 138.

ABOVE: The identical marble-topped vanities were designed to be functional and elegant. Vintage mirrors lend a touch of texture. **OPPOSITE, TOP LEFT:** The shower's angular walls are clad in white crackled subway tile accented by a darker grout that picks up the gray tones in the mosaic floor tiles. **OPPOSITE, TOP RIGHT:** Marble trim outlines the shower niche, creating subtle interest. **OPPOSITE, BOTTOM LEFT:** The window seat includes a pair of built-in cubbies that the homeowners use to store bathroom necessities. **OPPOSITE, BOTTOM RIGHT:** A window alcove provides clever display and storage space, while a pair of arches with a built-in shelf frames the toilet.



bright idea

Skip the tub in a guest bath; most visitors prefer a shower.

